



Wild Ones

NATIVE PLANTS, NATURAL LANDSCAPES

SPRING 2021 • *Journal* • VOL. 34, NO. 1



*A voice for the natural landscaping movement.
Working toward the next four decades of growing native plants
and restoring natural landscapes.*

The Native Garden Designs are here!

By Katie Huebner

Wild Ones recently debuted a collection of seven professionally designed, native garden plans free for the public to use specific to the ecoregions of Chattanooga, Chicago, Milwaukee, Minneapolis, St. Louis, Tallahassee and Toledo. An eighth design for the ecoregion of Boston is forthcoming. The designs were supported by a grant from the Stanley Smith Horticultural Trust and can be downloaded from Wild Ones' newly launched nativegardendesigns.wildones.org website.

Each design also includes a digital plant list featuring color photos of each native plant that can be downloaded and easily printed for quick reference while selecting plants at a local nursery. The nativegardendesigns.wildones.org website also features a list of nationwide nurseries that are great sources for obtaining native plants.

The designs were created with the premise that using native plants in landscaping can be beautiful, promote wildlife, and be achievable for gardeners of all skillsets in terms of scope and budget.

While each designer approached their ecoregion specific design differently because all gardens are unique works of art, all of the designers followed a set of guidelines determined by Wild Ones to be important goals/considerations for any native garden.

The guidelines specified

- inclusion of at least 15 or more native plant species
- encouraging the use of multiples of plants rather than "specimen" plantings to be consistent with building attractive pollinator gardens per Xerces and other science-based pollinator advocates.
- favoring species with long and staggered bloom times to enhance the ornamental nature of the gardens and provide pollen and nectar through the season.



- inclusion of considerations concerning soil (type/texture, pH, etc.), and other conditions (moisture, sunlight) typical for the specific ecoregion)
- inclusion of an incremental approach in developing their plan, adding new areas and native plant species as time and funds permit.

Wild Ones had the pleasure of collaborating with six talented designers from around the country to produce these seven gorgeous designs. Here is a little bit of information about each of the designers.

Meet the designers



Caleb Melchior (Chattanooga/Tallahassee)

Caleb Melchior is a landscape architect and planting designer based in the southeastern U.S. He's

currently working with Coastal Vista Design on Sanibel Island in southwest Florida. Caleb has a master's degree in landscape architecture from Kansas State University, along with

extensive experience designing fine gardens and country estates. His work is frequently published in national gardening and design publications, including *Land8*, *Horticulture* and *The American Gardener*. You can follow Caleb on his blog (calebmelchior.com/journal) or on Instagram @the_curious_gardener. Melchior creates gardens rooted in a deep knowledge of regional plant communities and ecosystems. His goal is to design planting that's delightful and surprising, but thrives within the constraints of the site. He aims to provoke a deeper appreciation and enjoyment of the natural world.



**Monica Buckley
(Chicago design)**

Designer Monica Buckley's childhood home featured an organic garden, a big compost pile and

rows of her dad's irises, bred and grown for show. The garden was a source of wonder, but true entrancement took hold when a kid from her block showed her caterpillars, chrysalises and cocoons, and shared the names of butterflies, moths and the plants their larvae needed to eat. That sense of the interconnectedness of nature colored her world, and after a career in publishing, Monica decided to follow her original passion. After several years of classes from The Morton Arboretum and the Chicago Botanic Garden and with encouragement from her mentor, Art Gara, she took the leap in 2013. Her company, Red Stem Native Landscapes, designs, builds and cares for native plant gardens in and around Chicago.



Danielle Bell (Milwaukee design)

Growing up in rural Wisconsin, Danielle Bell explored the natural world starting in the oak hickory woodland of her

parent's home. While working in the green industry and on restoration projects she noticed the disconnect



humans have with our landscapes, especially in the urban environment. The restoration projects that she managed focused on largescale projects and not with homeowners and their smaller urban properties. Seeing this need, she began Native Roots, LLC to help homeowners incorporate native plants into their landscapes. She uses her experience from restoring native wetlands, prairies, and woodlands throughout Southeastern Wisconsin to inspire her residential designs. Her passion is to restore sterile turf monocultures into healthy, sustainable, diverse habitats that both people and wild-

life can enjoy. As part of helping homeowners create healthy, functional landscapes, she educates them on how to sustainably manage their property through invasive species monitoring and plant identification.



**Carmen Simonet
(Minneapolis design)**

Carmen Simonet is a landscape architect with a passion for using native plants. She has over 25 years

of experience providing landscape master planning and site design services for commercial developments, public parks and private gardens.

She is the owner of [Carmen Simonet Design LLC](#). Recent projects include design of a natural playscape for a child development center, consulting on the landscape design for a conservation development, designing lakeshore buffer plantings and residential gardens seeking to replace lawn with native habitats! Carmen received her bachelor's and master's degrees in landscape architecture from the University of Minnesota.



Susie Van de Riet (St. Louis design)

Susie Van de Riet is the founder of [St. Louis Native Plants LLC](#), whose services include consulting,

coaching, design and education. She obtained her bachelor's in women's studies and AAS in horticulture. She is an ISA certified arborist and an NAI certified interpretive guide. She has a passion for native plants and has been landscaping with them since 2009. Susie has served as Education Subcommittee Chair of Grow Native! and has participated with the St. Louis Audubon Society's "Bring Conservation Home" program as a habitat adviser. She is a member of Grow Native! and Wild Ones and worked as a horticulturist managing 130+ acres at Forest Park. Her last yard was Platinum Certified with the BCH program, and she has attained the same certification for her current yard. She loves sharing the benefits of native plants with others.



Susan Hall (Toledo design)

Susan Hall is passionate about using native plants in home landscapes. As a landscape designer and certified horticulturist, she feels

it's important to educate homeowners on the many benefits of native plants in their home landscape. She grew up in Toledo, Ohio and was introduced to native plants by members of the Oak Openings Wild Ones Chapter. A move 10 years ago took her to Berkeley County in West

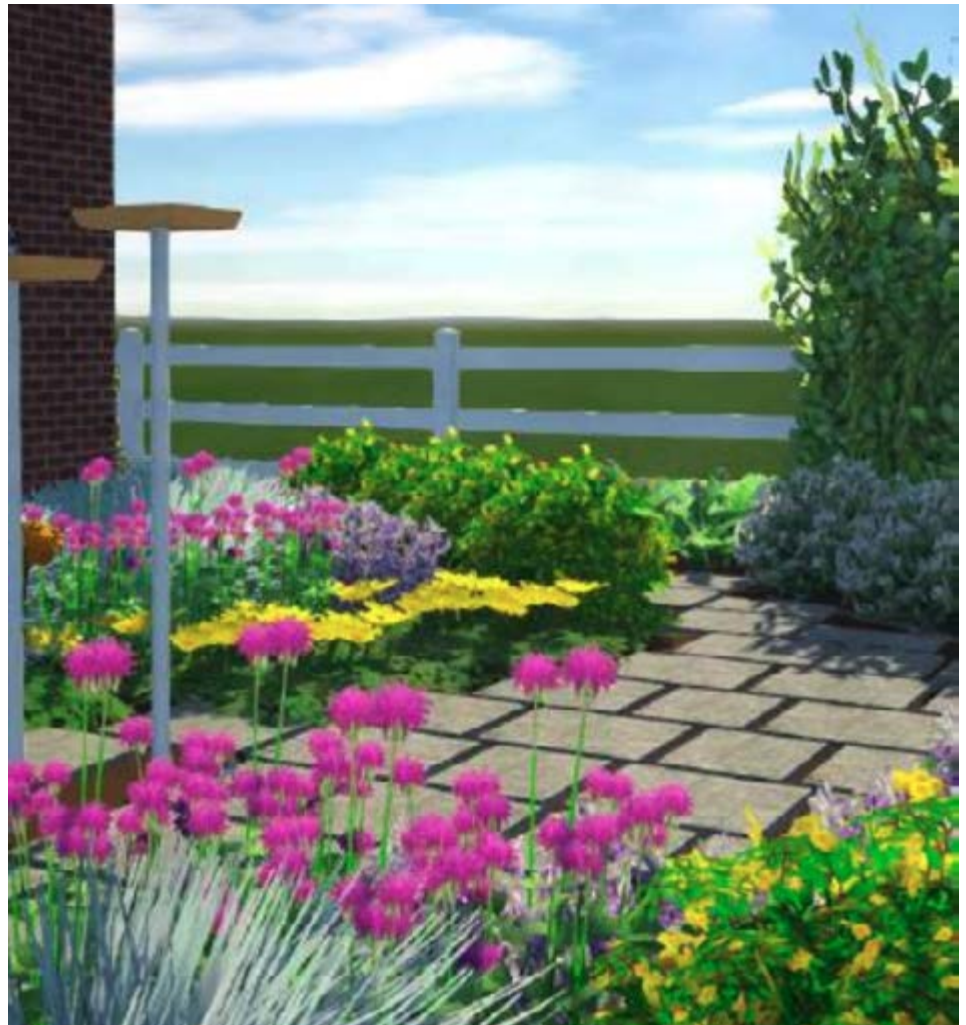

Virginia, where she designed both residential and commercial spaces. She currently lives in Corpus Christi, Texas near her parents. In addition to her design work, her focus now is creating a landscape design program for Del Mar Community College's Continuing Education Program. The most popular class to date is Xeriscape Management, which focuses on entirely native plants. Examples of Susan's work can be found on her YouTube channel, Hidden in a Garden Design.



Denise Gehring (Toledo design)

Since her youth, Denise Gehring has encouraged others to directly experience nature and become stewards of our natural world. After an active career as a naturalist, then director of Environmental Programs for Metroparks Toledo, she discov-

ered Wild Ones. Since 2008, she has enjoyed serving on local and national Wild Ones boards, especially Wild for Monarchs, Seeds for Education, establishing chapter native landscape and youth awards, and most recently, the Stanley Smith Horticultural Trust Native Beauty project. In 1990, Denise co-founded the Oak Openings Natives project so that the public would have a dependable source of local genotype native plants and seeds for home landscapes and to boost home grown conservation of the region. Because of her botanical expertise, she serves as a native plant consultant recommending beneficial native species for residential, public and commercial projects including world headquarters. Denise is a member of the Oak Openings Native Plant Working Group, a native plant consultant, rare plant monitor and works as an Ohio Natural Areas & Preserves field botanist.